

# Conferences and Meetings at Mordialloc Life Saving Club



## Conferences & Meetings

MLSC is located on an idyllic section of Port Phillip Bay with expansive views through Arthurs' Seat to the South and the You Yangs to the North.

Members and friends have enjoyed the facility for sporting and social events for nearly one hundred years.

## Room Hire Only

The long room is available for casual hire and can accommodate up to 24 people in a classroom or boardroom setting with more in a theatre setting.

Complete with tables, chairs, whiteboard and a TV to connect your own laptop it also offers Mipro wireless audio.  
Hire the room from just an hour to a whole day.

Your choice of set up is available and catering can be arranged.  
The Long Room may not be available on weekends as full venue bookings take precedence.

The Hazel Pierce Hall can accommodate up to 70 guest's theatre style and has the added advantage of a projector and drop-down screen, kitchenette and access to the deck.

## Audio Visual

Audio visual display systems are available throughout function rooms and they include:

- Roving Microphone
- Ipod connection
- Wireless internet connection
- Visual display flatscreens and projector with USB / HDMI connections
- Piped speakers via RC jack for use with ipod, iphone, computer etc.
- Mipro wireless audio

## Venue Inclusions

Venue access by prior arrangement.  
Tables, chairs, the service kitchen and the deck are included in the hire of the venue.

- On hand are:
- 6 x small round tables (0.8m dia)
  - 4 x large round tables (1.8m dia)
  - 5 x round bar tables (0.6m dia)
  - 20 x trestle tables (1.8m x .75m)
  - 120 x white dining chairs

Venue setup is the responsibility of the hirer.  
The club can offer a set up service charged at \$40 an hour or part there of by prior arrangement.

The layout of the function area at Mordialloc Life Saving Club is pictured below.

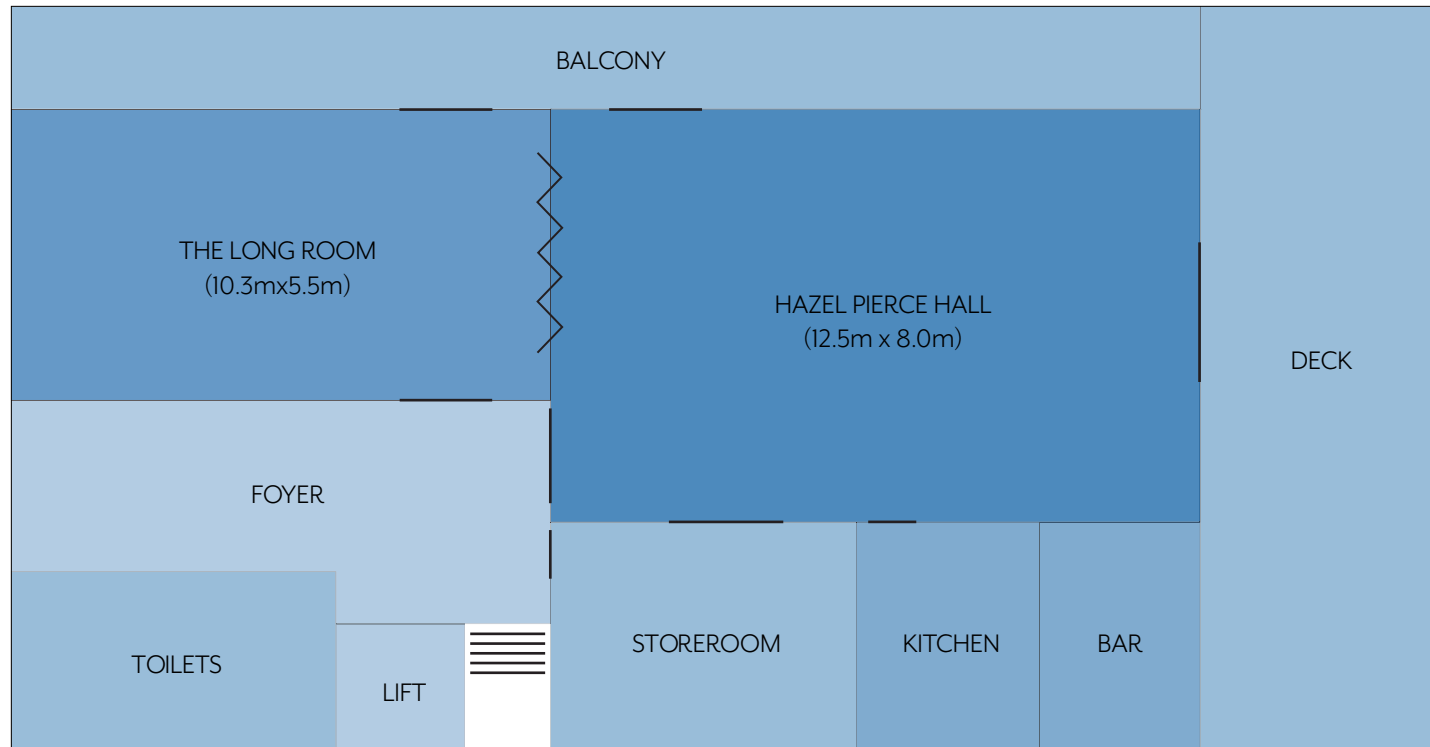
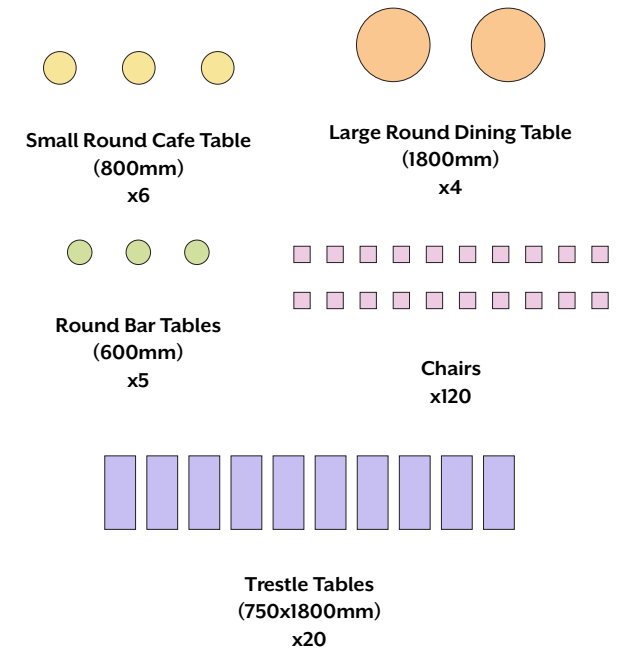



## Beverages

Soft drinks and juices are available as well as a fully licenced bar featuring Two Brothers beer on tap and a range of wine and ciders. Beverages may be purchased on consumption, as a cash bar (guests pay) or a time limited beverage package.

Beverage packages are suggested for larger events and a staff surcharge may apply for events with less than 40 guests.

A temporary liquor licence may be required for some events and a \$50 Social Membership fee will be required to open bar from 12noon Wednesday to Sunday (bar not available Monday or Tuesday)

## Silver

2 hour duration \$21 p/p  
3 hour duration \$30 p/p  
4 hour duration \$38 p/p  
5 hour duration \$45 p/p

### **Beverages include:**

Two Brothers Beer on Tap  
Carlton Draught  
Cascade Light  
Westwood Cuvee Blanc  
Thieven' Devlin  
Sem Sav Blanc and Shiraz  
Twelve Signs  
Chardonnay  
Cab Merlot  
Soft Drinks  
Spirits available at \$8 per glass



## Gold

2 hour duration \$25 p/p  
3 hour duration \$35 p/p  
4 hour duration \$44 p/p  
5 hour duration \$52 p/p

### **Beverages include:**

Two Brothers Beer on Tap  
Two Brothers Cider  
Corona  
Astrid Prosecco  
Kokori Sauvignon Blanc NZ  
The Impressionist Pinot Grigio  
Yarrowood White Label Shiraz  
Red Hill Estate Pinot Noir  
San Pellegrino Sparkling  
Soft Drinks  
Spirits available at \$8 per glass

## Catering

The club offers a range of day packages from morning to afternoon tea, working sandwich lunch, board room snack boxes, ploughman's lunch or a gourmet BBQ.

You can view these packages on the following page.

For stand-up events such as product launches a cocktail menu may be the best idea.

To tailor your individual needs please contact our catering manager.

## Tea / Coffee Sideboard

**\$4.5 pp / min 10**

*1-hour duration*

Tea and coffee side board set up in meeting room with kettle or hot water urn, Chamellia specialty tea, Moccona coffee, fresh juice and mineral water

## Cold Boardroom Boxes

**\$19.5 pp / min 20**

Your choice of two of the following ordered prior to event:  
Cajun chicken Caesar, grilled lamb and Greek salad, smoked salmon or tuna niçoise or Chorizo and Mediterranean vegetable pasta salad

## Standard/ Gourmet BBQ

**Standard BBQ**

**\$27.5 pp / min 10**

Mixed snags, beef and chicken burgers, selection of breads & buns with condiments

**Gourmet BBQ**

**\$35.0pp / min 10**

Add in skewers and lamb chops Both come with 2 x seasonal salads of your choice

N.B. vegetarian options available

## Morning or Afternoon Tea

**\$12.5 pp / min 10**

*1-hour duration*

Your choice of three of the following items served on boards:  
Banana bread, mini muffin selection, assorted cake, Danish pastries and fruit pastries. Sweet or savory tartlets, cupcakes, seasonal fruit skewers and bruschetta  
Extra items charged at \$2.5 per piece pp

## Hot Boardroom Boxes

**\$22.5 pp / min 20**

Your choice of two of the following ordered prior to event:  
Thai beef stir-fry with rice noodles, Teriyaki chicken and Asian greens with hokkien noodles  
Italian sausage Matriciana with penne or spiced lamb meatballs, pinenuts, spinach tossed with farfalle (bow ties)

## Canape Selection

**From \$35.0 pp / min 20**

Includes waiter service to hand around finger food for approximately an hour

Savoury muffins or scones  
Arancini with semi dried tomato aioli  
Cocktail spring rolls with chili & soy dipping mayo  
Selection of sandwiches, wraps or mini buns  
Variety of savoury mini quiches  
Warmed gourmet party pies and sausage rolls with tomato relish

Optional extras may be added and some suggestions are;  
Mini burgers, pulled pork sliders, salt & pepper calamari, king prawns, oysters, chicken wings or skewers

## Working Sandwich Lunch

**\$18.5 pp / min 10**

A selection of sandwiches and wraps or mini buns and a fresh fruit platter  
Sushi platter selection add \$4.0pp  
Orange juice or soft drink in jugs add \$3.0pp

## Ploughman's Lunch

**\$25.0pp / min 10**

Share plates of cured meats, farmhouse cheese selection, English pork pie, vegetable dips, pickles, potato & egg salad and salad greens and a fresh fruit platter



## Delivery of Goods to the Club

Access is available through the club carpark with an unloading area off a large roundabout only a short distance from the main entrance and foyer.

Long term parking is not available here and once vehicles are unloaded they must be relocated.

## Bookings and Bond

A bond of \$500 is required to book the venue date and will be held in trust against any misfortunate damage that may arise.

## Music

As our venue is located adjacent to a residential area music must not be audible outside the venue.

We appreciate your co-operation with this request.

Music is required to cease half an hour prior to departure or when the bar closes.

## Conclusion

Bar service will conclude at an agreed time or no later than 11:30pm when liquor licence expires. guests must depart within half an hour of this time.

Charges will be incurred at \$250 per hour or part thereof past the departure deadline.

## Payments

Confirmation of definitive guest numbers and a comprehensive guest list is required 7 days prior to the event and deposits are strictly non-refundable within 30 days of the proposed function date.

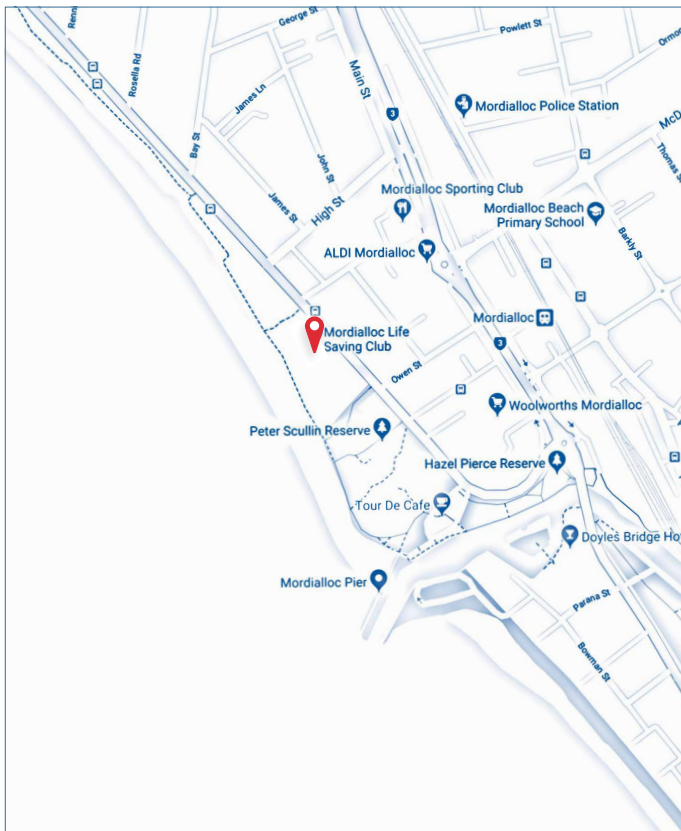

## How to get to MLSC

Towards the southern end of Beach Road turn right in to the club car parking area (opposite 199 Beach Road, Mordialloc). Here you will find a limited number of public parking spaces, however there is ample parking along Beach Road in both directions and paid carparks both to the North and South.

## Transport

Taxi 13CABS  
UBER  
Train to Mordialloc Station  
Bus to Mordialloc Bus Interchange

## Decorations

Venue, tables and surrounds may be decorated by you at your cost. Confetti, party poppers or any water leachable material must not be used.

Any damage to furniture or facilities will be charged for at cost price of repair.

## Confirmation

Bookings will be confirmed with your bond deposit and a signed copy of the Venue Hire Booking Form.

Deposits may be processed by EFTPOS (in person), credit card over the phone or via bank transfer upon receipt of invoice.

## Cleaning Charge

It is compulsory to employ our contract cleaner after all events. Rates are shown in the table of fees and applies so long as the Club is left in reasonable condition.

Extra charges will apply should there be broken glass, excessive cleaning or rubbish removal after the conclusion of the event.

## Security

Required at the discretion of the board and at all functions serving alcohol.

Charges will apply at cost price for the duration of the function plus ½ hour in and ½ hour out.

## Smoking

Is not permitted within the venue or on the deck or within 4 metres of any entrance to the building.



199 Beach Road, Mordialloc  
[www.mlsc.com.au](http://www.mlsc.com.au)